

G SERIES GEAR SPEED REDUCER



ISO9001

Distributed by:



THONG FATT JAYA MACHINERY HARDWARE SDN. BHD.

同發機械五金有限公司 (176024-V)

707-709, Jalan Kuala Kangsar, Taman Tasek Jaya,
31400 Ipoh, Perak. Malaysia.

Tel: 00-605-5468 659, 5455 751, 5479 196, 5454 107

Fax: 00-605-5482 282, 5474 753

Email: tfjaya@tm.net.my / tfjaya@streamyx.com

Website: <http://www.thongfattjaya.com.my>

STRUCTURE FEATURES

1. High strength and high reliability.
2. Aluminium housing or cast iron housing. It is high intensity and long life.
3. Compact structure.
4. Low noise.

WORKING CONDITIONS

1. Ambient temperature range: -10°C~+40°C
2. Working temperature: <80°C
3. Gear speed reducers are lubricated with synthetical lubricant.

MOTOR

1. This series reducer is connected with electric motor or brake motor directly. Standard IEC flange is adapted for the IEC Standard flange-mounted motor. (please see page 7).



PUMP KEY

G L F 28 - 0.55 - 50 - 90

G H W 32 - K90B5 - 30

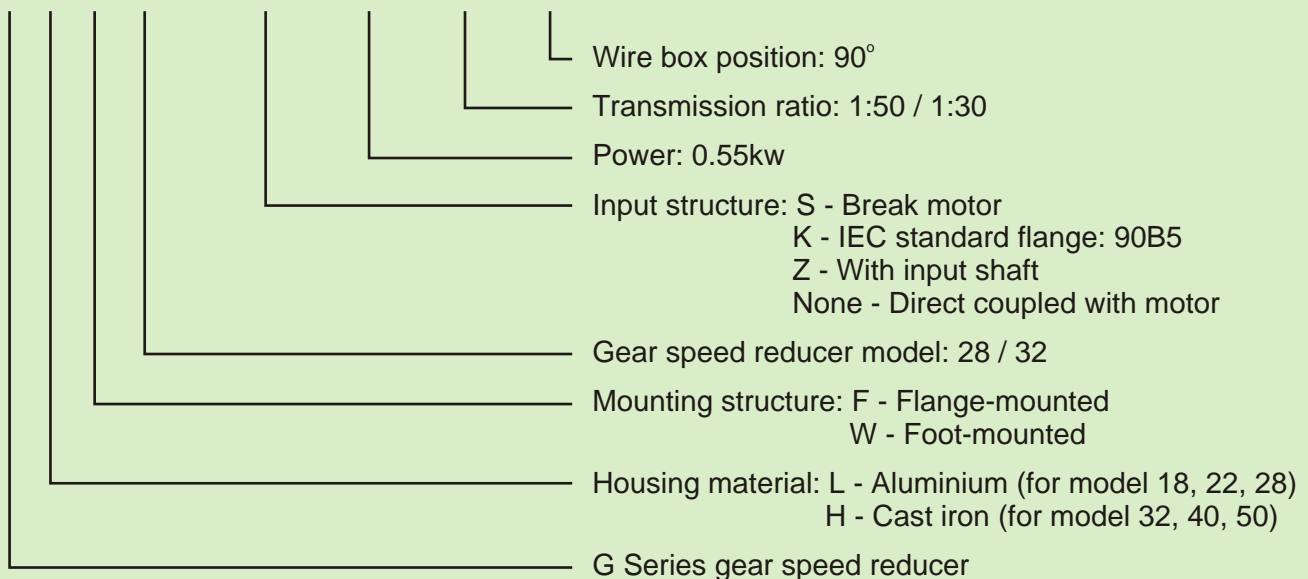

STRUCTURE design

G Series gear speed reducers are available in the following structure designs:

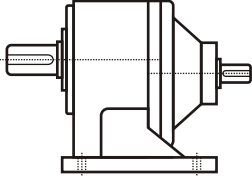
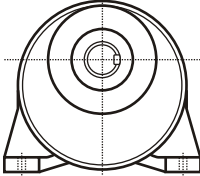
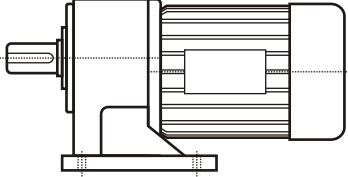
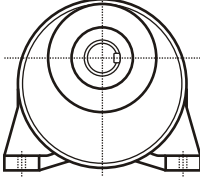
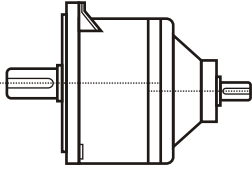
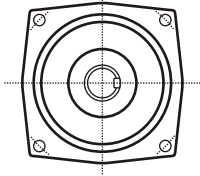
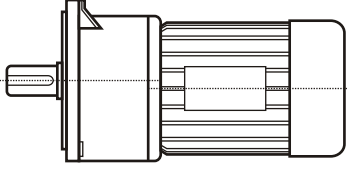
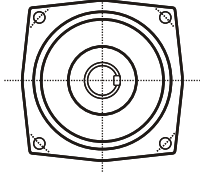
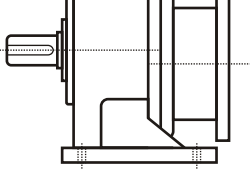
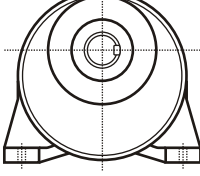
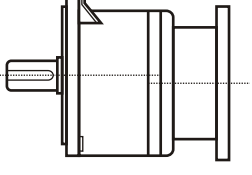
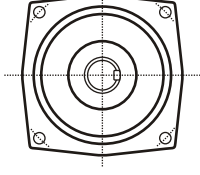
<p>GLW...Z GHW...Z (see pg.6)</p>			<ul style="list-style-type: none"> * Foot-mounted. * With input shaft.
<p>GLW GHW (see pg.6)</p>			<ul style="list-style-type: none"> * Foot-mounted. * Direct coupled with motor.
<p>GLF...Z GHF...Z (see pg.6)</p>			<ul style="list-style-type: none"> * Flange-mounted. * With input shaft.
<p>GLF GHF (see pg.6)</p>			<ul style="list-style-type: none"> * Flange-mounted. * Direct coupled with motor.
<p>GLW...K GHW...K (see pg.7)</p>			<ul style="list-style-type: none"> * Foot-mounted. * With flange for mounting IEC Standard motor.
<p>GLF...K GHF...K (see pg.7)</p>			<ul style="list-style-type: none"> * Flange-mounted. * With flange for mounting IEC Standard motor.

MOUNTING CONSTRUCTION

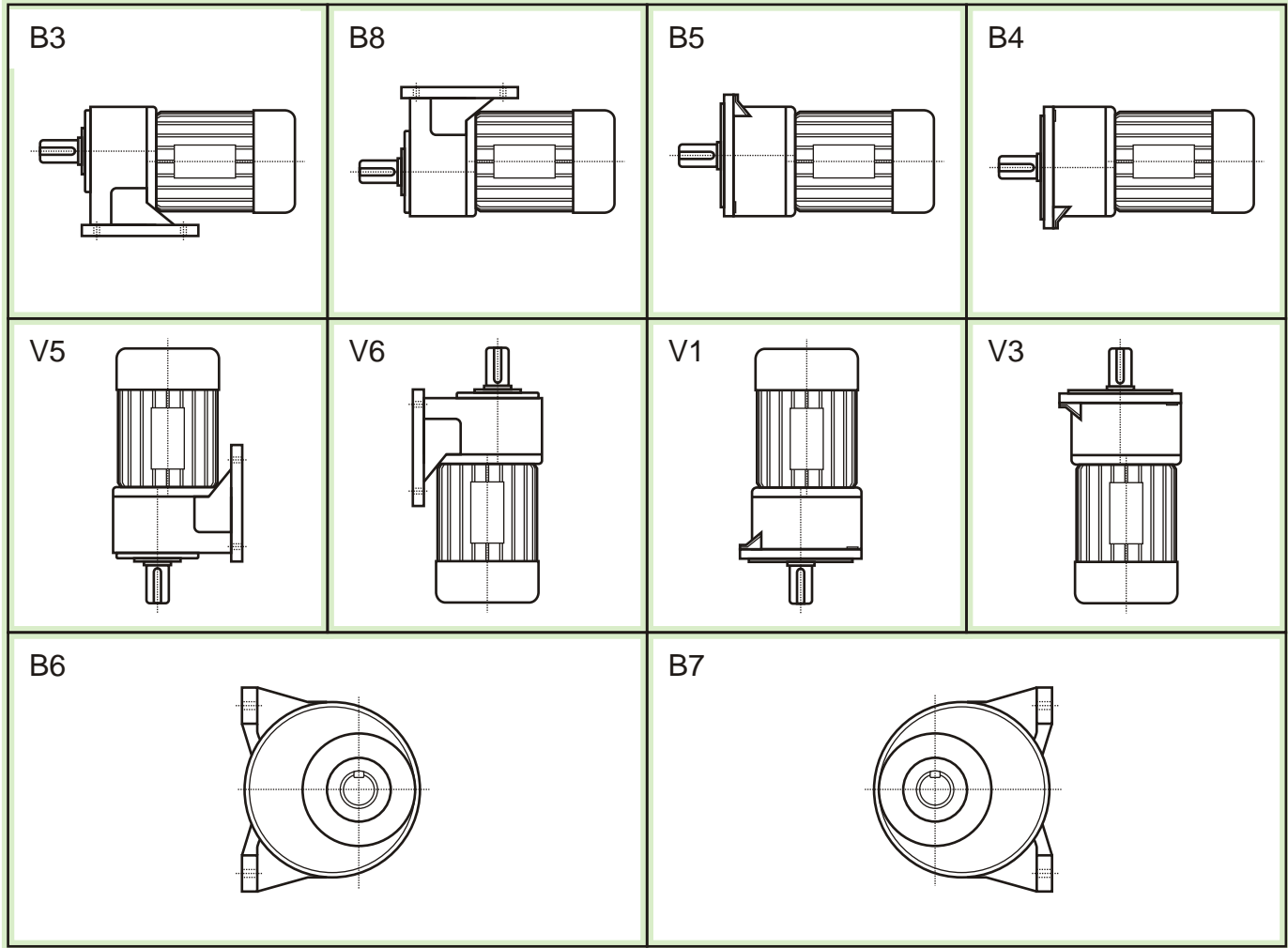

WIRE BOX POSITION

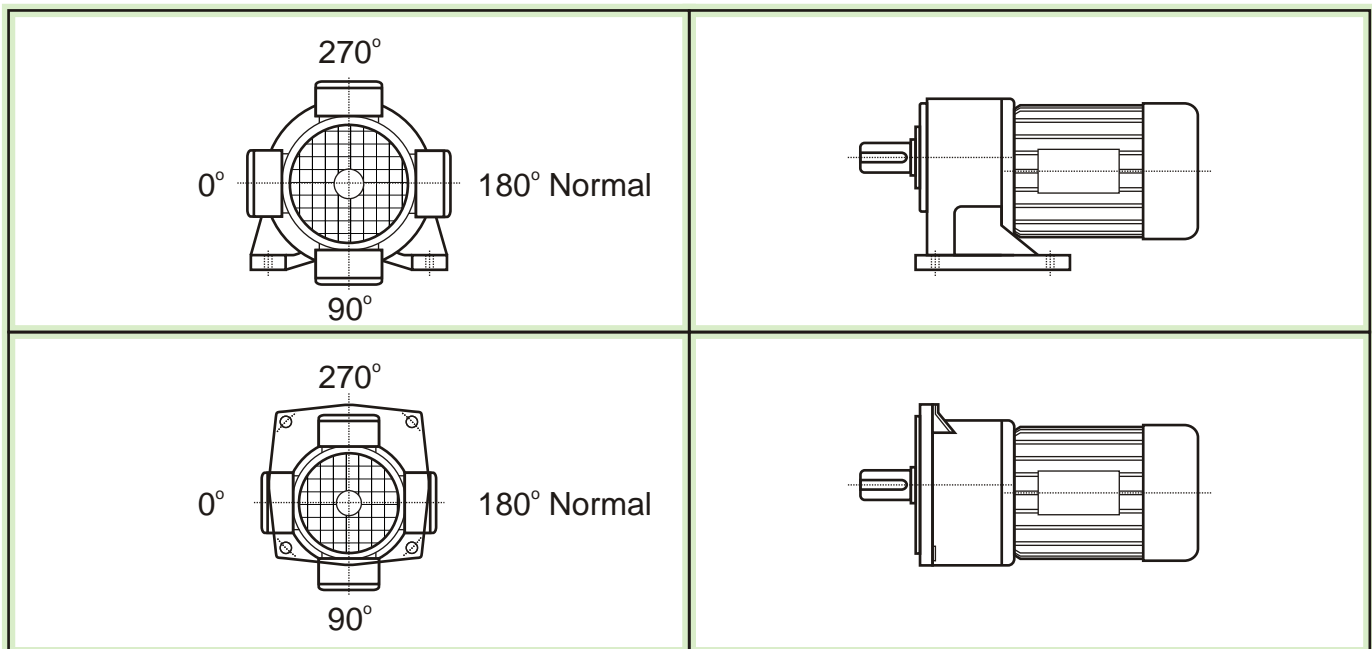

SELECTION GUIDE

Model selection should be satisfied the following formula:
 $KA \times Ma \leq [M]$
 KA: Service factor
 Ma: Output torque
 [M]: Permitted output torque

Model	Permitted Output Torque (N.m.)
G18	56
G22	225
G28	350
G32	550
G40	820
G50	1550

WORKING SERVICE FACTOR ~ KA

Prime Mover	Working Hours/Day	KA Working Service Factor		
		Slight Impact Load	Middle Impact Load	Strong Impact Load
Electric Motor	<0.5	0.8 (0.9)	0.9 (1.0)	1.0 (1.25)
	0.5~2	0.9 (1.0)	1.0 (1.25)	1.25 (1.5)
	2~10	1.0 (1.25)	1.25 (1.5)	1.5 (1.75)
	10~24	1.25 (1.5)	1.5 (1.75)	1.75 (2.0)

* Note: When turn on / turn off the reducer more than 10 times per hour, please use the KA data in the brackets.

SPECIFICATION DATA 1~4 POLES

Input Power (kw)	Model	Output Speed (rpm)	Output Torque (N.m)	Ratio
0.12	G22	7	154	200
		9	139	180
		12	123	160
		14	92	120
		18	77	100
		23	62	80
	G18	28	46	60
		35	39	50
		47	31	40
		56	24	30
		70	16	20
		93	12	15
		140	8	10
		280	4	5
0.18	G22	7	231	200
		9	208	180
		12	185	160
		14	139	120
		18	116	100
		23	92	80
	G18	28	69	60
		35	59	50
		47	47	40
		56	35	30
		70	24	20
		93	18	15
		140	12	10
		280	6	5
467	4	3		

Input Power (kw)	Model	Output Speed (rpm)	Output Torque (N.m)	Ratio
0.25	G28	7	321	200
		9	289	180
		12	257	160
		14	193	120
		18	160	100
		23	128	80
	G22	28	96	60
		35	82	50
		47	65	40
		56	49	30
		70	33	20
		93	25	15
		140	16	10
		280	8	5
0.37	G28	7	475	200
		9	428	180
		12	380	160
		14	285	120
		18	238	100
		23	190	80
	G22	28	143	60
		35	121	50
		47	97	40
		56	73	30
		70	48	20
		93	36	15
		140	24	10
		280	12	5
467	7	3		

SPECIFICATION DATA 2~4 POLES

Input Power (kw)	Model	Output Speed (rpm)	Output Torque (N.m)	Ratio
0.55	G32	7	706	200
		9	635	180
		12	565	160
		14	424	120
		18	353	100
		23	282	80
	G28	28	212	60
		35	180	50
		47	144	40
		56	108	30
		70	72	20
		93	54	15
		140	36	10
		280	18	5
467	11	3		
0.75	G40	7	963	200
		9	866	180
		12	770	160
	G32	14	78	120
		18	481	100
		23	385	80
		28	289	60
	G28	35	246	50
		47	196	40
		56	147	30
		70	98	20
		93	74	15
		140	49	10
		280	25	5
467		15	3	
1.1	G50	7	1412	200
		9	1271	180
		12	1129	160
	G40	14	847	120
		18	706	100
		23	565	80
		28	424	60
	G32	35	360	50
		47	288	40
		56	216	30
		70	144	20
		93	108	15
		140	72	10
		280	36	5
467	22	3		

Input Power (kw)	Model	Output Speed (rpm)	Output Torque (N.m)	Ratio	
1.5	G50	7	1925	200	
		9	1733	180	
		12	1540	160	
	G40	14	1155	120	
		18	963	100	
		23	770	80	
		28	578	60	
		35	491	50	
	G32	47	393	40	
		56	295	30	
		70	196	20	
		93	147	15	
		140	98	10	
		280	49	5	
467		29	3		
2.2	G50	14	1695	120	
		18	1412	100	
		23	1130	80	
		28	847	60	
	G40	35	717	50	
		47	574	40	
		56	430	30	
		70	287	20	
		93	215	15	
		140	143	10	
		280	72	5	
		467	43	3	
	3	G50	23	1540	80
			28	1155	60
G40		35	978	50	
		47	782	40	
		56	587	30	
		70	391	20	
		93	293	15	
		140	196	10	
		280	98	5	
		467	59	3	
4	G50	35	1304	50	
		47	1043	40	
		56	782	30	
		70	521	20	
		93	391	15	
		140	261	10	
		280	130	5	
467	78	3			

INSTALLATION DIMENSION 1

GLW...Z / GHW...Z

- * Foot-mounted.
- * With input shaft.

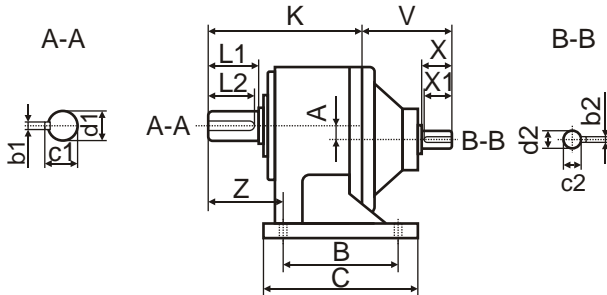

GLW / GHW

- * Foot-mounted.
- * Direct coupled with motor.

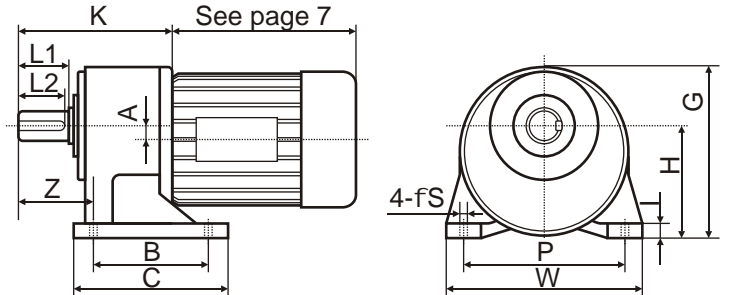

Model	Mounting Dimensions (mm)						Shaft Dimensions (mm)										Overall Dimensions (mm)					Weight (Kg)	
							A-A Output Shaft					B-B Input Shaft											
	A	B	P	H	S	Z	L1	L2	d1	b1	c1	X	X1	d2	b2	c2	V	K	G	W	C		I
G18	16.5	40	110	85	9	45	30	25	18	6	20.5	25	22	14	5	16	66	105	130	134	64	10	7.5
G22	18	65	130	90	11	55	40	35	22	6	24.5	25	22	14	5	16	66	125	140	154	90	12	10
G28	22	90	140	110	11	65	45	40	28	8	31	30	25	16	5	18	79	142	165	170	120	16	15
G32	27	130	170	130	13	70	55	50	32	10	35	30	25	19	6	21.5	86.5	167	198	203	164	18	32
G40	32.5	150	210	150	18	93	65	60	40	12	43	35	30	24	8	27	109.5	195	227	255	200	20	45
G50	40	160	230	170	18	105	75	70	50	14	53.5	50	45	35	10	38	125	227	267	285	210	25	73

GLF...Z / GHF...Z

- * Flange-mounted.
- * With input shaft.

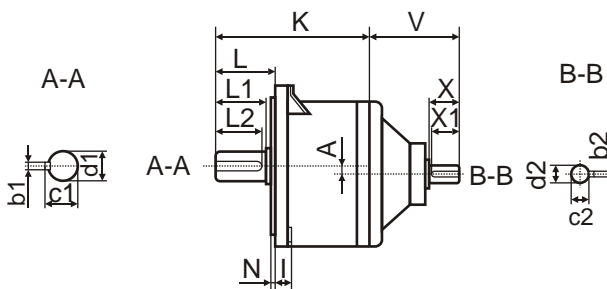

GLF / GHF

- * Flange-mounted.
- * Direct coupled with motor.

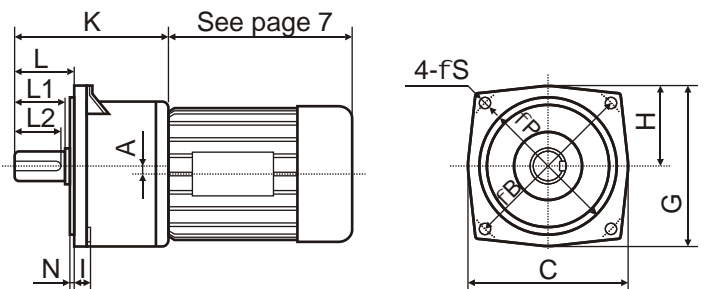

Model	Mounting Dimensions (mm)						Shaft Dimensions (mm)										Overall Dimensions (mm)					Weight (Kg)	
							A-A Output Shaft					B-B Input Shaft											
	A	B	P	H	S	N	L1	L2	d1	b1	c1	X	X1	d2	b2	c2	V	K	G	L	C		I
G18	16.5	170	145	80.5	9	3	30	25	18	6	20.5	25	22	14	5	16	66	105	158	33	154	12	7.5
G22	18	185	148	79.5	11	4	40	35	22	6	24.5	25	22	14	5	16	66	125	165	44	165	12	10
G28	22	215	170	94	11	4	45	40	28	8	31	30	25	16	5	18	79	142	193	49	186	16	15
G32	27	250	180	108	13	4	55	50	32	10	35	30	25	19	6	21.5	86.5	167	230	59	213	18	32
G40	32.5	310	230	130	18	5	65	60	40	12	43	35	30	24	8	27	109.5	195	283	70	262	20	45
G50	40	360	270	150	18	5	75	70	50	14	53.5	50	45	35	10	38	125	227	331	80	302	25	73

INSTALLATION DIMENSION 2

GLW...K / GHW...K

- * Foot-mounted.
- * With flange for mounting IEC Standard motor.

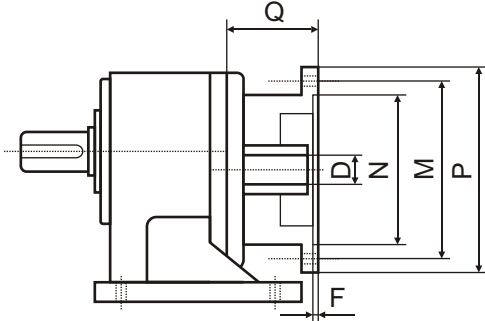

GLF...K / GHF...K

- * Flange-mounted.
- * With flange for mounting IEC Standard motor.

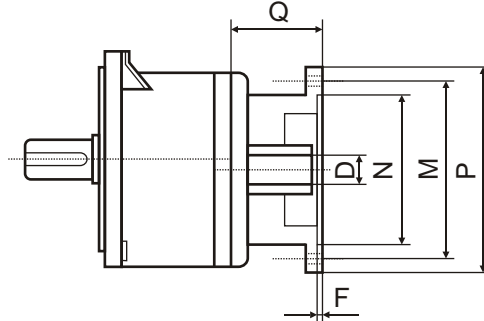

Model	Flange Size	Power		Mounting Dimensions (mm)					
		(kw)	(hp)	N	M	P	D	Q	F
G18	631-4-B5	0.12	0.16	95	115	140	11	45	4
	632-4-B5	0.18	0.25						
G22	631-4-B5	0.12	0.16	95	115	140	11	45	4
	632-4-B5	0.18	0.25						
	711-4-B5	0.25	0.34	110	130	160	14	55	4.5
	712-4-B5	0.37	0.5						
G28	711-4-B5	0.25	0.34	110	130	160	14	55	4.5
	712-4-B5	0.37	0.5						
	801-4-B5	0.55	0.75	130	165	200	19	58.5	4.5
	802-4-B5	0.75	1						
G32	801-4-B5	0.55	0.75	130	165	200	19	58.5	4.5
	802-4-B5	0.75	1						
	90S-4-B5	1.1	1.5	130	165	200	24	75	4.5
	90L-4-B5	1.5	2						
G40	802-4-B5	0.75	1	130	165	200	19	58.5	4.5
	90S-4-B5	1.1	1.5						
	90L-4-B5	1.5	2	180	215	250	28	80.5	5
	100L1-4-B5	2.2	3						
100L2-4-B5	3	4							
G50	90S-4-B5	1.1	1.5	130	165	200	24	75	4.5
	90L-4-B5	1.5	2						
	100L1-4-B5	2.2	3	180	215	250	28	80.5	5
	100L2-4-B5	3	4						
	112M-4-B5	4	5.5	180	215	250	28	80.5	5

Direct coupled with motor

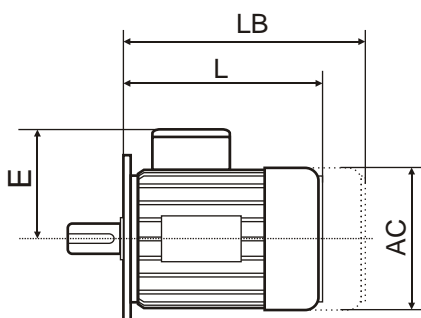

Motor Frame	Power		Mounting Dimensions (mm)			
	(kw)	(hp)	L	*LB	AC	E
631-4	0.12	0.16	209	301	144	134
632-4	0.18	0.25	209	301	144	134
711-4	0.25	0.34	255	347	145	110
712-4	0.37	0.5	255	347	145	110
801-4	0.55	0.75	285	372	166	145
802-4	0.75	1	285	372	166	145
90S-4	1.1	1.5	310	439	180	150
90L-4	1.5	2	355	464	180	150
100L1-4	2.2	3	385	498	175	175
100L2-4	3	4	385	498	175	175

Note: * LB is a dimension of brake motor.