



Three Phase Brake Motor BMA Series



ISO9001

CE



DISTRIBUTED BY:



THONG FATT JAYA MACHINERY HARDWARE SDN. BHD.

同發機械五金有限公司 (176024-V)

707-709, Jalan Kuala Kangsar, Taman Tasek Jaya,
31400 Ipoh, Perak, Malaysia.
Tel: 00-605-5468 659, 5455 751, 5479 196, 5454 107
Fax: 00-605-5482 282, 5474 753
Email: tfjaya@streamyx.com / tfjaya@tm.net.my
Website: <http://www.thongfattjaya.com.my>

Due to the policy of constant research and development, specifications may change without prior notice.
Copyright © Thong Fatt Jaya Machinery Hardware Sdn. Bhd.

C.N.: MONTROLI-D Section B01 / 140320051
BMA - PAGE 1000

INTRODUCE

MONTROLI™ BMA Series three-phase brake motors are made to IEC and GB Standards, also up to the international latest design technology. The power range of brake motor is from 0.25kw up to 3kw in 4 frame sizes from 71 up to 100L to satisfy variable applications.

MOTOR FEATURES

- * Aluminium alloy whole casting with heat sink design for better cooling effect.
- * Corrosive-resistant & vermin resistant.
- * Weather-proof, water-proof & dust-proof.
- * Precise dynamic balance adjustment and adopts high quality bearings to ensure smooth and silent operation.
- * The brake is made of wearable material without asbestos. It can provide the dry friction break torque.
- * DC transformer is not required. The AC connection is more safe and reliable.
- * Powerful brake effect, high break efficiency and frequency.
- * When a preset sealing device of the output shaft is connected with the variator or reducer, the sealing performance is more safe and reliable.
- * Assembled with manual release handle easy for installing or adjusting.
- * The brake plate and rotary shaft are connected with the steel key tooth, it can bear the strong impact during the brake process.
- * There is a superior interchangeability between the IEC Standard and IM mounted forms.
- * Low power consumption.
- * Compact size & light weight.
- * Good appearance.
- * Superior life.



OPERATING CONDITIONS

- * Standard voltage supply: 3 Phase, 415V/50Hz (380V~440V and 60Hz are available on request).
- * Protection class : IP54, IP55.
- * Insulation class : Montroli™ motors meet Class F insulation (temperature limit 145°C). (Other degree of protection class and insulation class are available on request.)
- * Cooling method: TEFV (Totally-Enclosed Fan Ventilated). (Cooling standard: GB/T1993-93; IEC34-6.)

MAIN MATERIALS

- * Motor cover: Aluminium alloy; Brake cover: Cast iron.
- * Shaft: 40Cr steel with heat refined.
- * Electro-magnetic wire: POLY-QZ-2; POLYMIDE-QY-2.
- * Silicon steel plate: DR490-510.
- * Ball bearing: NSK, NTN or SKF bearings.

PAINTS

- * Shot-blasting and antiseptic treatment on aluminium alloy surface.
- * Blue acrylic acid baking paint on steel parts surface.

Model	Output Power		Current (A)	Power Factor (COSf)	M_{st}/M_N	M_{max}/M_N	$J \times 10^{-4}$ (Kg.m ²)	A.C.T. max (N.m.)	D.C.T. max (N.m.)	Z_0
	(KW)	(HP)								
415V/50Hz Speed 2800r.p.m. (2 Poles)										
BMA711-2	0.37	0.50	0.96	0.80	2.3	2.3	5.37	13.5	8.5	5700
BMA712-2	0.55	0.75	1.35	0.82	2.3	2.3	6.05	13.5	8.5	5700
BMA801-2	0.75	1	1.75	0.85	2.2	2.3	12.80	17.5	14	5700
BMA802-2	1.1	1.5	2.55	0.85	2.2	2.3	14.20	17.5	14	5700
BMA90S-2	1.5	2	3.44	0.85	2.2	2.3	20.90	37	29	4280
BMA90L-2	2.2	3	4.83	0.86	2.2	2.3	24.15	37	29	4280
BMA100L-2	3.0	4	6.39	0.87	2.2	2.3	43.88	50	41	2650
415V/50Hz Speed 1400r.p.m. (4 Poles)										
BMA711-4	0.25	0.34	0.83	0.68	2.4	2.4	7.95	13.5	8.5	19000
BMA712-4	0.37	0.50	1.12	0.72	2.4	2.4	8.95	13.5	8.5	18050
BMA801-4	0.55	0.75	1.56	0.73	2.4	2.4	16.48	17.5	14	9500
BMA802-4	0.75	1.0	2.01	0.75	2.3	2.4	18.91	17.5	14	9500
BMA90S-4	1.1	1.5	2.75	0.78	2.3	2.3	28.77	37	29	14250
BMA90L-4	1.5	2	3.65	0.79	2.3	2.3	33.59	37	29	11400
BMA100L1-4	2.2	3	5.03	0.82	2.2	2.3	56.33	50	41	7600
BMA100L2-4	3.0	4	6.82	0.81	2.2	2.3	66.18	50	41	6650
415V/50Hz Speed 930r.p.m. (6 Poles)										
BMA711-6	0.18	0.25	0.74	0.63	2.0	2.0	11.09	13.5	8.5	26000
BMA712-6	0.25	0.34	0.94	0.64	2.0	2.0	12.75	13.5	8.5	26000
BMA801-6	0.37	0.50	1.29	0.64	2.0	2.0	25.84	17.5	14	17000
BMA802-6	0.55	0.75	1.81	0.65	2.0	2.0	29.95	17.5	14	17000
BMA90S-6	0.75	1	2.19	0.70	2.0	2.2	39.88	37	29	17000
BMA90L-6	1.1	1.5	2.98	0.72	2.0	2.2	50.88	37	29	14000
BMA100L-6	1.5	2	3.90	0.74	2.0	2.2	96.33	50	41	10000

BMA71 DIMENSIONS

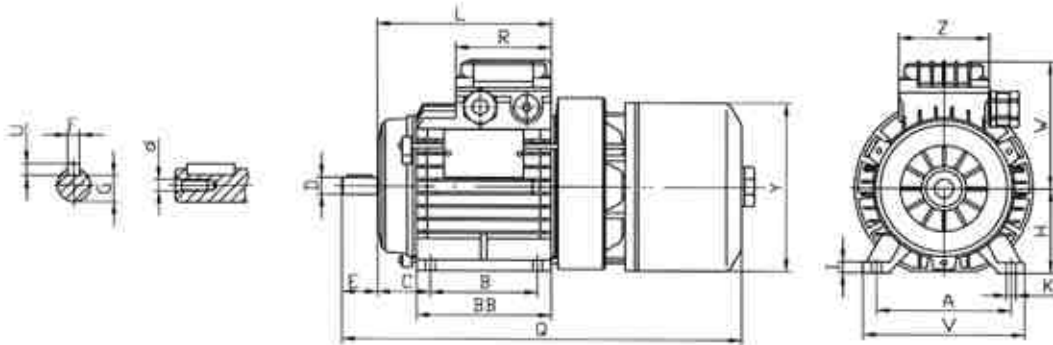

BMA71	112	90	43	14	30	5	11	71	10	336	5	136	108	140	113	147	80	75	8	M5
-B3-	A	B	C	D	E	F	G	H	I	Q	U	V	W	Y	BB	L	R	Z	K	D

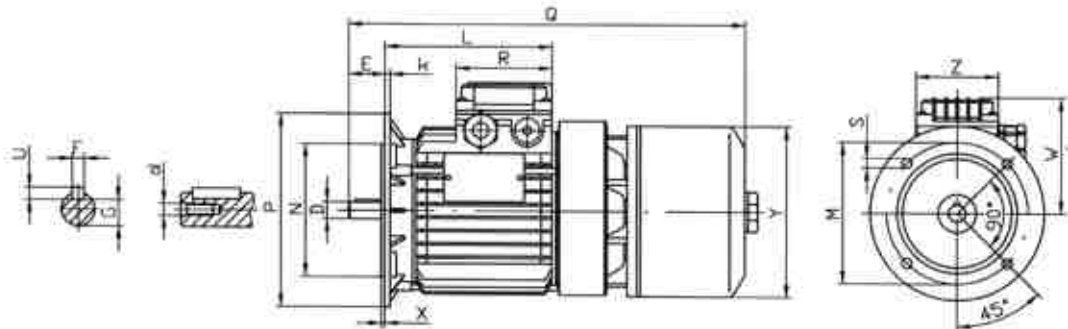

BMA71	14	30	5	11	135	110	160	330	10	5	107	3.5	140	141	80	75	7.5	M5
-B5-	D	E	F	G	M	N	P	Q	S	U	W	X	Y	L	R	Z	K	D

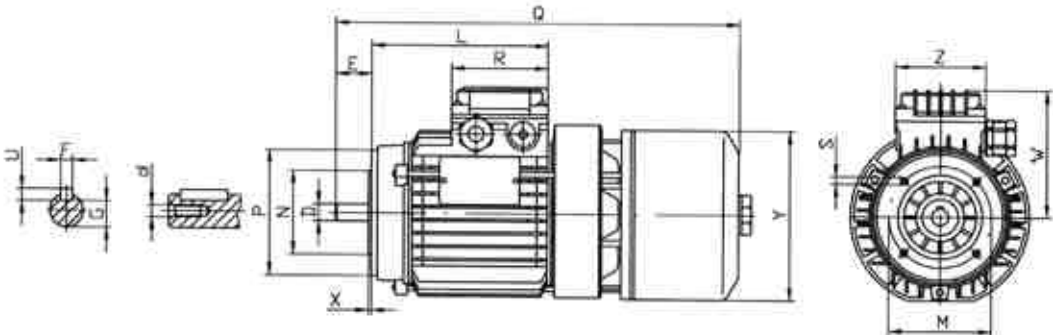

BMA71	14	30	5	11	135	110	160	330	10	5	107	3.5	140	141	80	75	7.5	M5
-B14-	D	E	F	G	M	N	P	Q	S	U	W	X	Y	L	R	Z	K	D

DOUBLE TERMINAL BOARD BOX

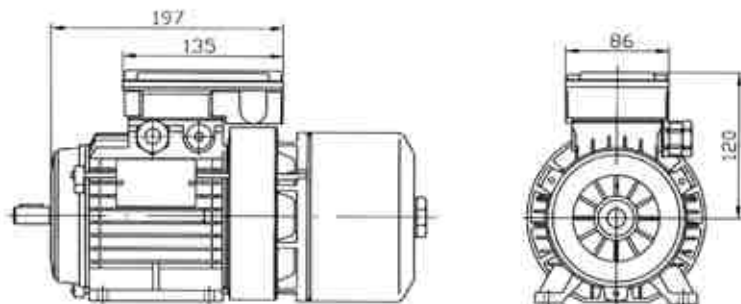

BMA80 DIMENSIONS

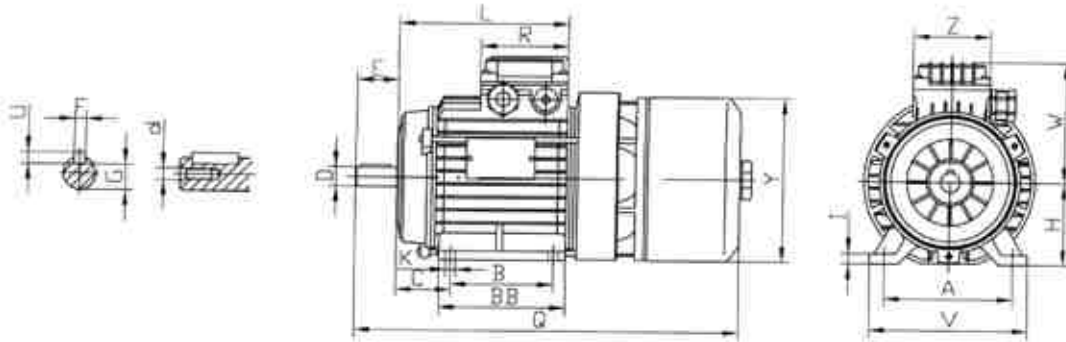

BMA80	125	100	51	19	40	6	15.5	80	10	372	6	154	118	160	125	167	80	75	10	M6
-B3-	A	B	C	D	E	F	G	H	I	Q	U	V	W	Y	BB	L	R	Z	K	D

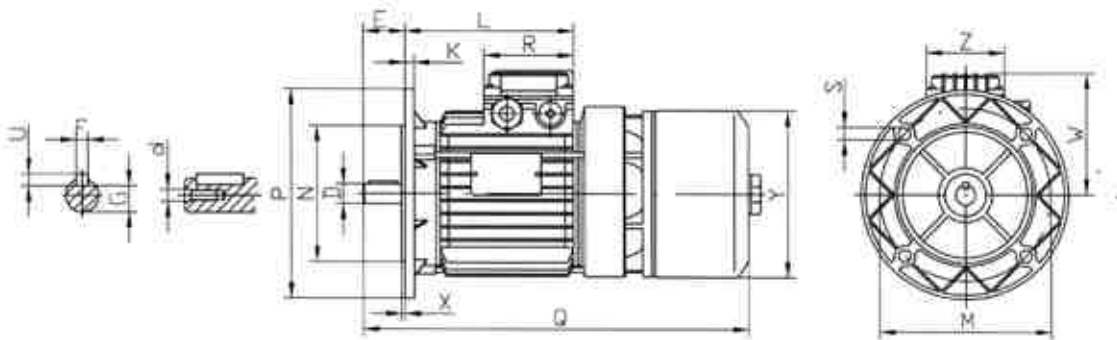

BMA80	19	40	6	15.5	165	130	200	368	12	6	118	3.5	160	163	80	75	9	M6		
-B5-	D	E	F	G	M	N	P	Q	S	U	W	X	Y	L	R	Z	K	D		

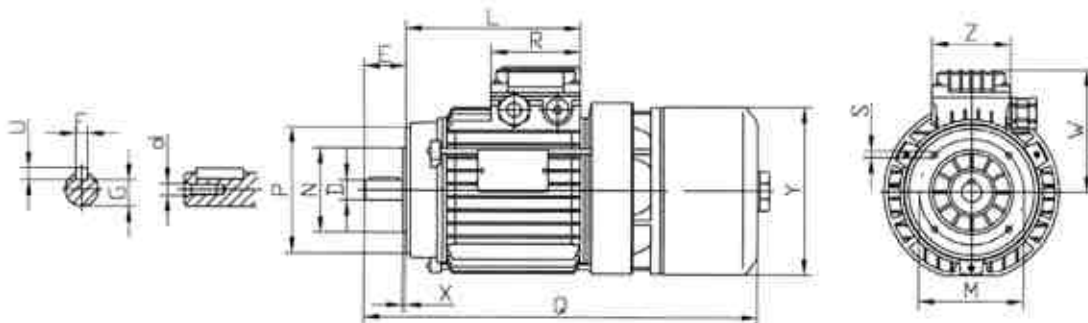

BMA80	19	40	6	15.5	100	80	120	372	M6	6	118	3	160	167	80	75	M6			
-B14-	D	E	F	G	M	N	P	Q	S	U	W	X	Y	L	R	Z	D			

DOUBLE TERMINAL BOARD BOX

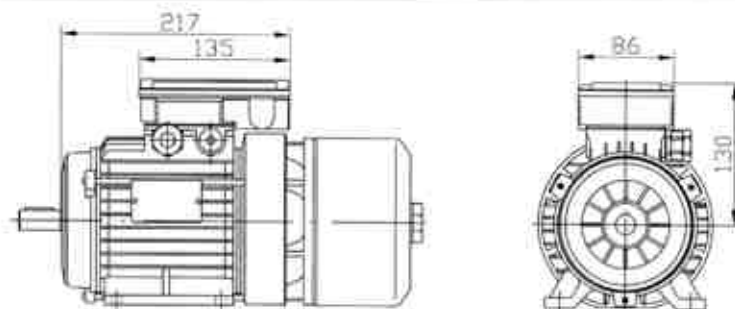

BMA90 DIMENSIONS

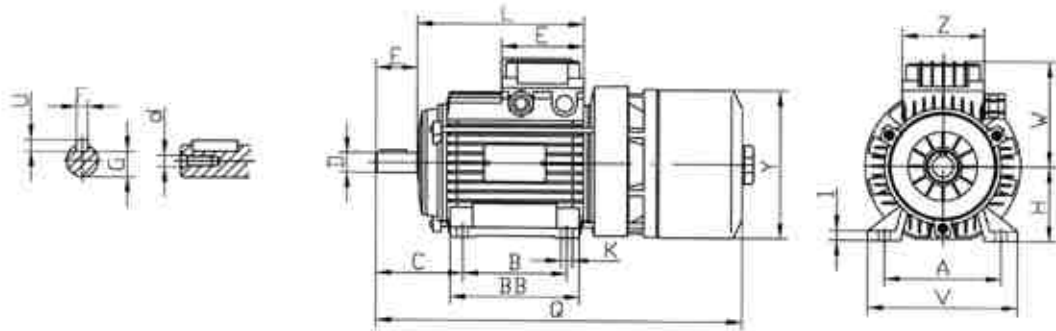

BMA90	140	125	56	24	50	8	20	90	12	439	7	180	128	180	155	201	98.5	98.5	10	M8
-B3-	A	B	C	D	E	F	G	H	I	Q	U	V	W	Y	BB	L	R	Z	K	D

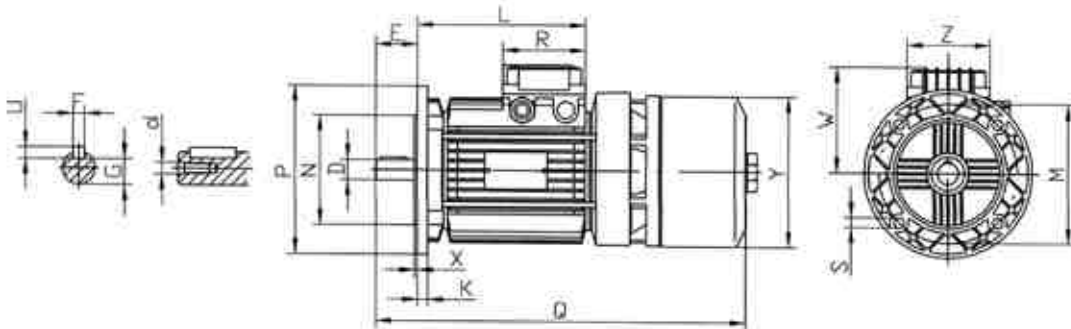

BMA90	24	50	8	20	165	130	200	439	12	7	128	3.5	180	202	98.5	98.5	M8	12		
-B5-	D	E	F	G	M	N	P	Q	S	U	W	X	Y	L	R	Z	D	K		

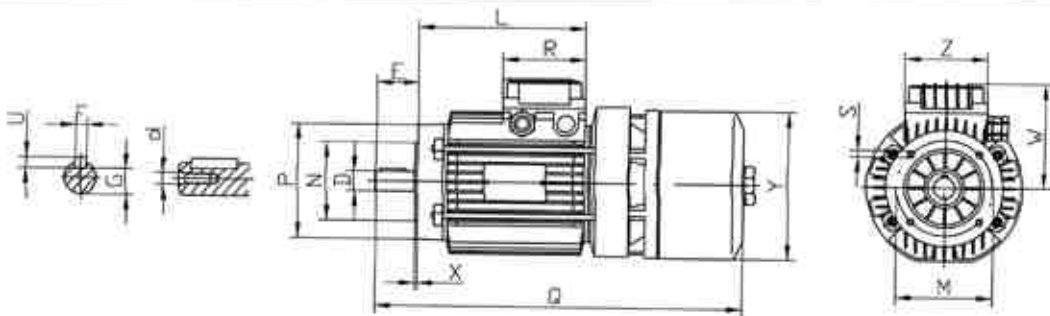

BMA90	24	50	8	20	115	95	138	439	M8	7	128	3	180	202	98.5	98.5	M8			
-B14-	D	E	F	G	M	N	P	Q	S	U	W	X	Y	L	R	Z	D			

DOUBLE TERMINAL BOARD BOX

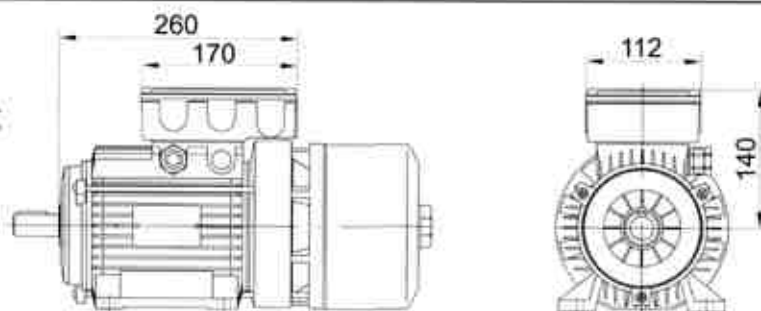

BMA100 DIMENSIONS

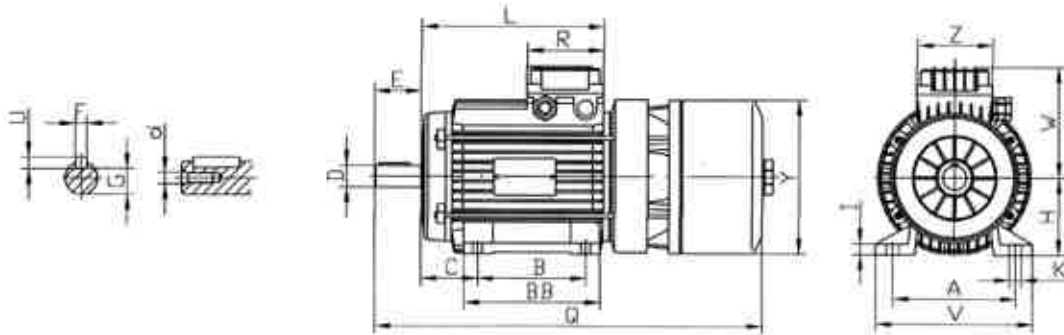

BMA100	160	140	75	28	60	8	24	100	14	498	7	205	145	200	176	237	98.5	98.5	12	M10
-B3-	A	B	C	D	E	F	G	H	I	Q	U	V	W	Y	BB	L	R	Z	K	D

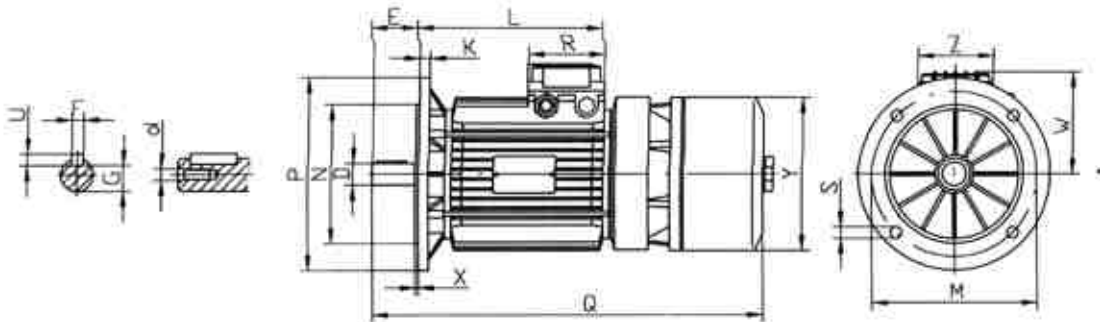

BMA100	28	60	8	24	215	180	250	498	15	7	145	4	200	238	98.5	98.5	13	M10		
-B5-	D	E	F	G	M	N	P	Q	S	U	W	X	Y	L	R	Z	K	D		

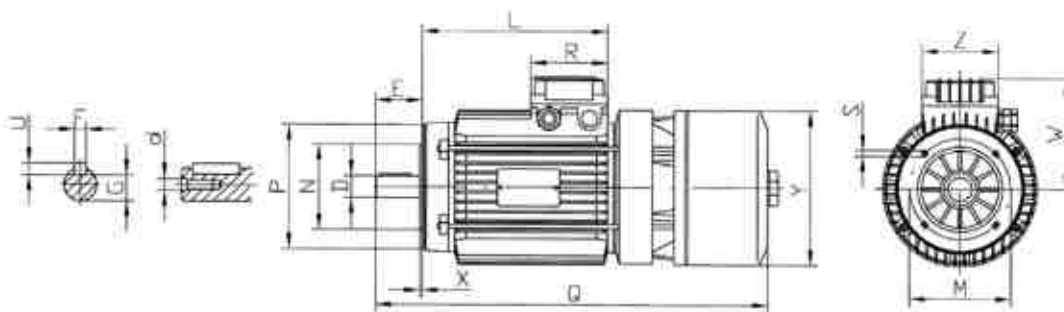

BMA100	28	60	8	24	130	110	160	498	M8	7	145	3.5	200	238	98.5	98.5	M10			
-B14-	D	E	F	G	M	N	P	Q	S	U	W	X	Y	L	R	Z	D			

DOUBLE TERMINAL BOARD BOX

