



END SUCTION CENTRIFUGAL PUMP SINGLE STAGE BACK PULL-OUT DIN24255

50HZ OR 60HZ



PA SERIES

APPLICATIONS

PA Series pumps can be used for the following services in commercial, residential, agriculture, industrial, processing, petroleum, food & beverage industries.

- * Air Conditioning
- * Fire Protection
- * Circulating
- * Irrigation
- * Pressure Boosting
- * Water Treatment & Supply
- * Refrigeration
- * Plumbing
- * Liquid Transfer
- * Drainage
- * De-watering
- * Cooling Towers
- * Water Heating



THONG FATT JAYA MACHINERY HARDWARE SDN. BHD.

同發機械五金有限公司 (176024-V)

707-709, Jalan Kuala Kangsar, Taman Tasek Jaya,
31400 Ipoh, Perak, Malaysia.
Tel: 00-605-5468 659, 5455 751, 5479 196, 5454 107
Fax: 00-605-5482 282, 5474 753
Email: tfjaya@streamyx.com / tfjaya@tm.net.my
Website: <http://www.thongfattjaya.com.my>

MATERIALS OF CONSTRUCTION		
Pump Parts	All Iron (AI)	Bronze Fitted (BF)
Casing	Cast Iron	Cast Iron
Impeller	Cast Iron	Bronze
Wear Ring	Cast Iron	Bronze
Shaft	S. Steel	S. Steel
Shaft Sleeve	S. Steel	S. Steel
Gland	Cast Iron	Cast Iron

PUMP KEY

PA 80 / 32 H

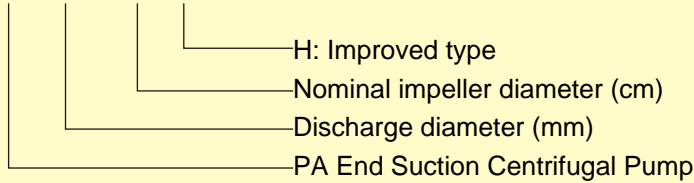

TECHNICAL INFORMATION

- * Design : DIN 24255
- * Operating pressure : 1000kPa standard; 1600kPa optional
- * Hydrostatic test pressure : 1500kPa standard; 2400kPa optional
- * Operating temperature : -10°C to +105°C standard; 160°C optional
- * Operating speed : 50 Hz, 1450rpm and 2900 rpm; 60 Hz, 1750rpm and 3500 rpm

FEATURE OF CONSTRUCTION

- * The PA Series Pumps meet the DIN 24255 specification for end suction, horizontal centrifugal pumps. The PA Series offers many features and benefits that improve performance, increase reliability and reduce maintenance time and cost.
- * Heavy-duty cast iron casing with integral cast feet suitable for 10 bar working pressure. Working pressures up to 16 bar also available. Centerline discharge assures that the casing is self-venting.
- * Flanges to ISO 2084 PN16 as standard. Also available with ASA 125# or JIS 10k drilling.
- * Back pull out design for fast and easy maintenance when fitted with a spacer type coupling because suction and discharge piping and drive motor remain in place.
- * Maximum interchangeability for low spare parts inventory with 4 bearing housings and 4 shaft sizes for 47 sizes of pumps.
- * Replaceable wear rings to assure optimum efficiency and performance at all times.
- * Shaft seal is available as packing or as mechanical seal to suit all types of applications.
- * Double shrouded, hydraulically balanced impellers with back vanes to minimize gland pressure in cast iron or bronze as standard. Also available in stainless steel or zinc free bronze.
- * Heavy-duty cast iron bearing housing with SKF greased ball bearings as standard. Also available with oil lubricated bearings.
- * Heavy-duty shaft in stainless steel for longer life and to assure product purity.
- * Stainless steel shaft sleeve for product purity, longer mechanical seal life and to prevent damage to the shaft from packing or mechanical seal.
- * Operating temperature from -10°C to +105°C as standard. Available for up to +160°C with cooling and suitable mechanical seal selection.
- * Suitable for both 50 cycle and 60 cycle speeds up to 3600rpm.

SELECTION CHART

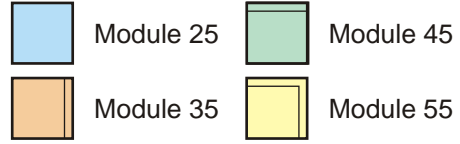

2900r.p.m. / 50Hz

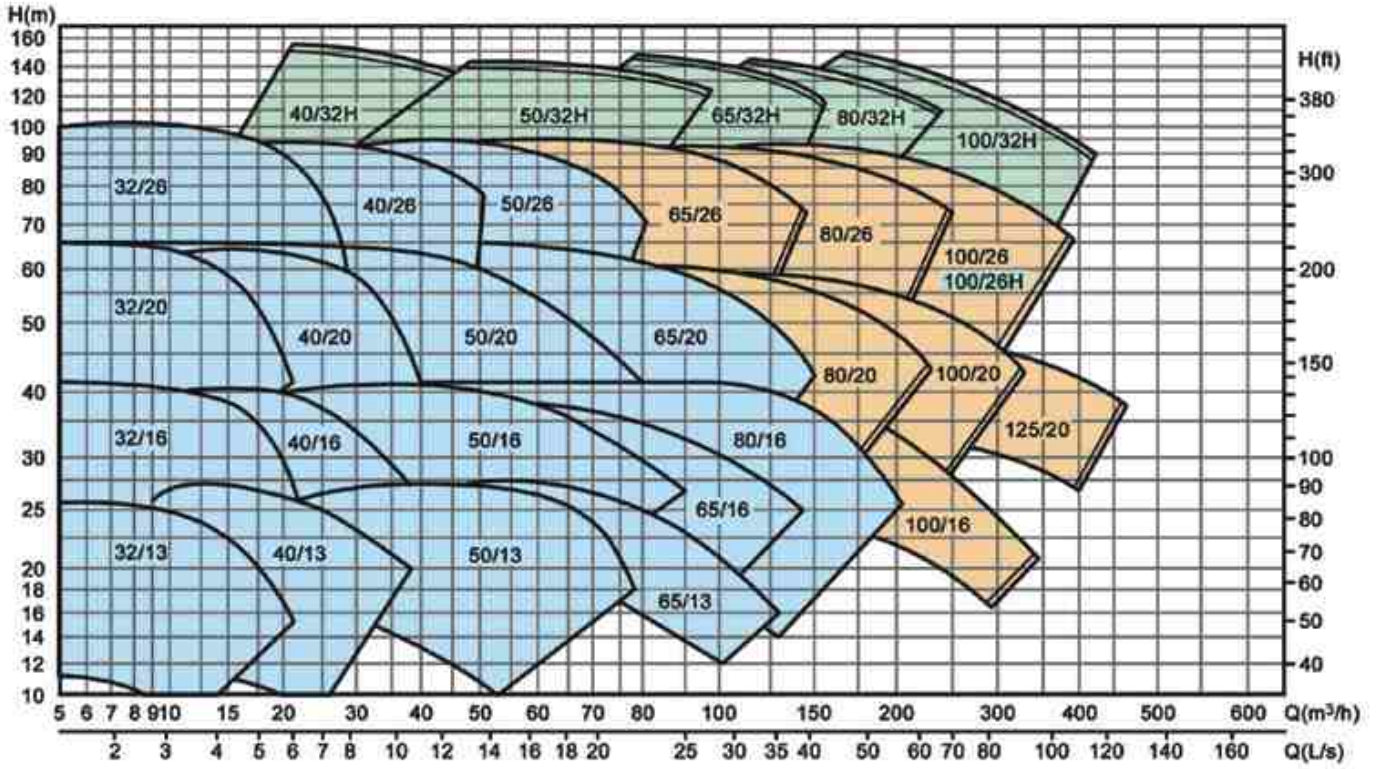

1450r.p.m. / 50Hz

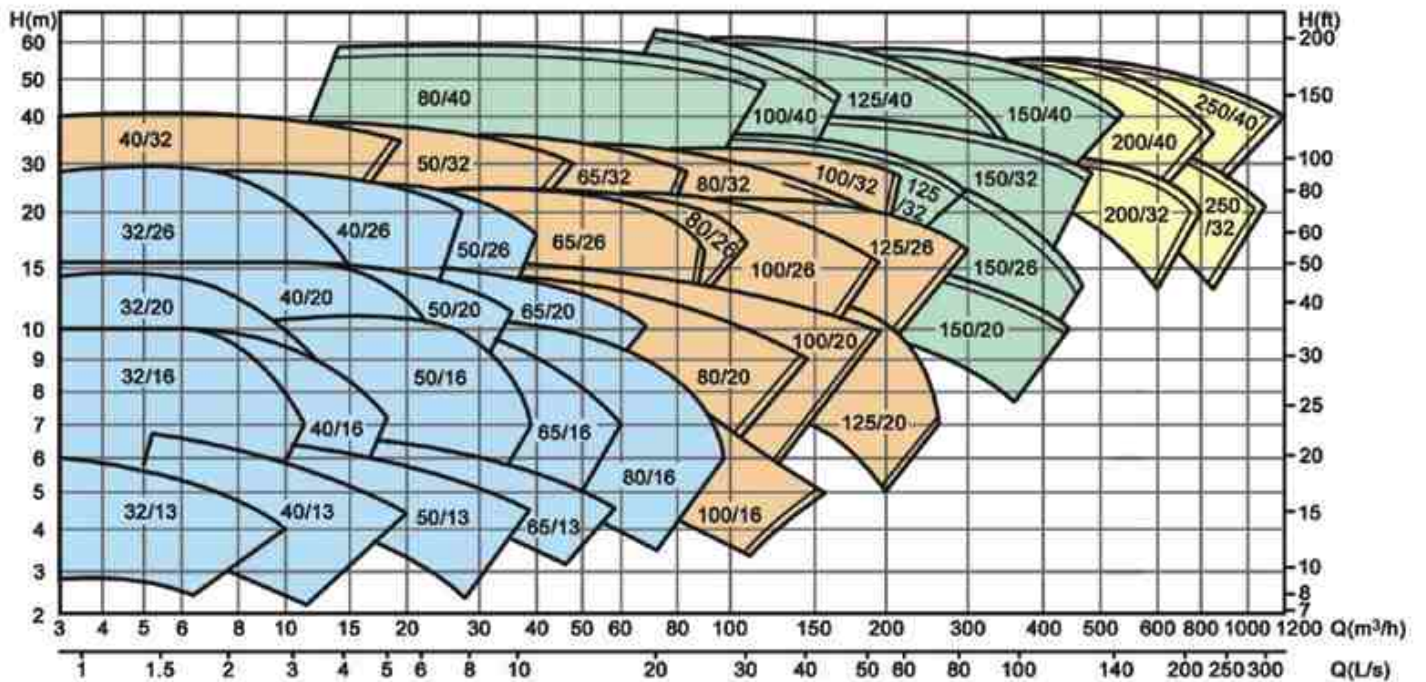

Performance curve of each model are available on request. The information is subject to change without prior notice.

SELECTION CHART

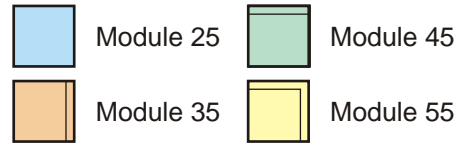

3500r.p.m. / 60Hz

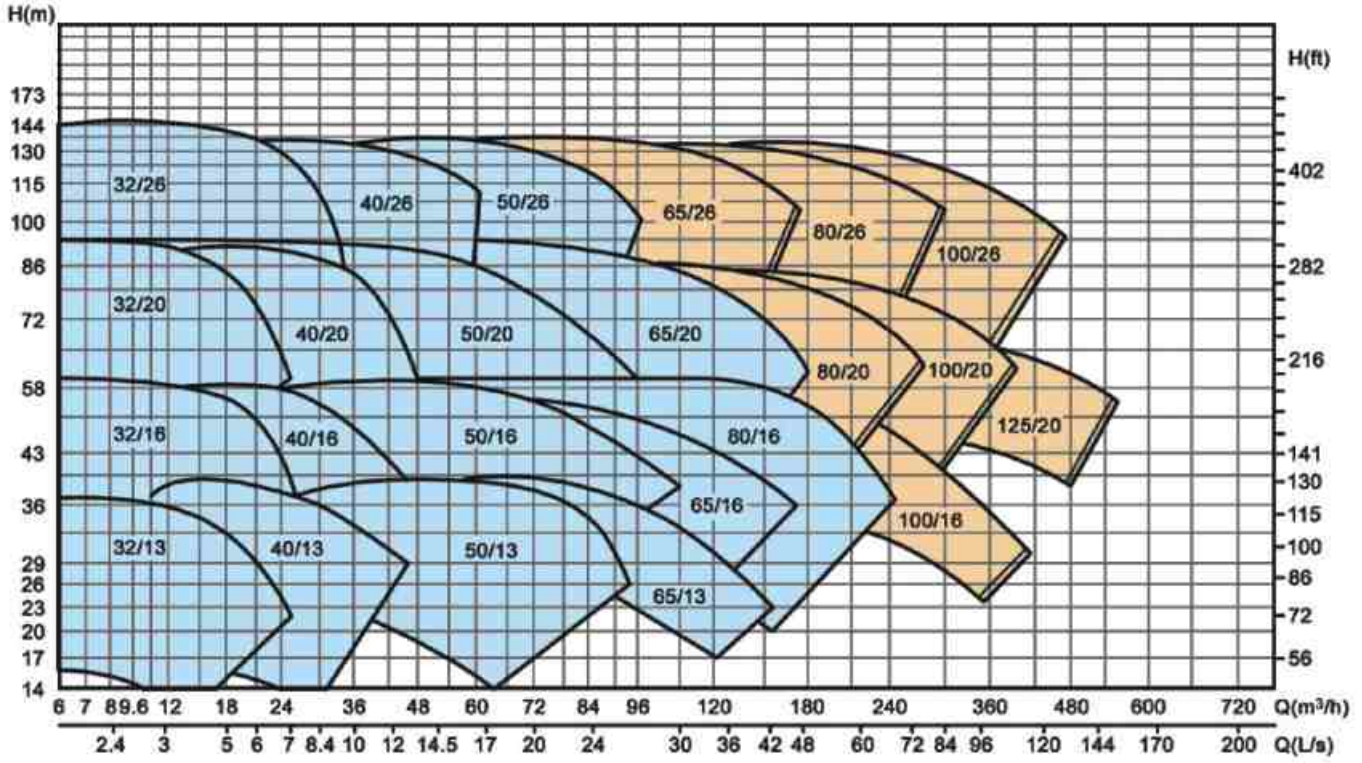

1750r.p.m. / 60Hz

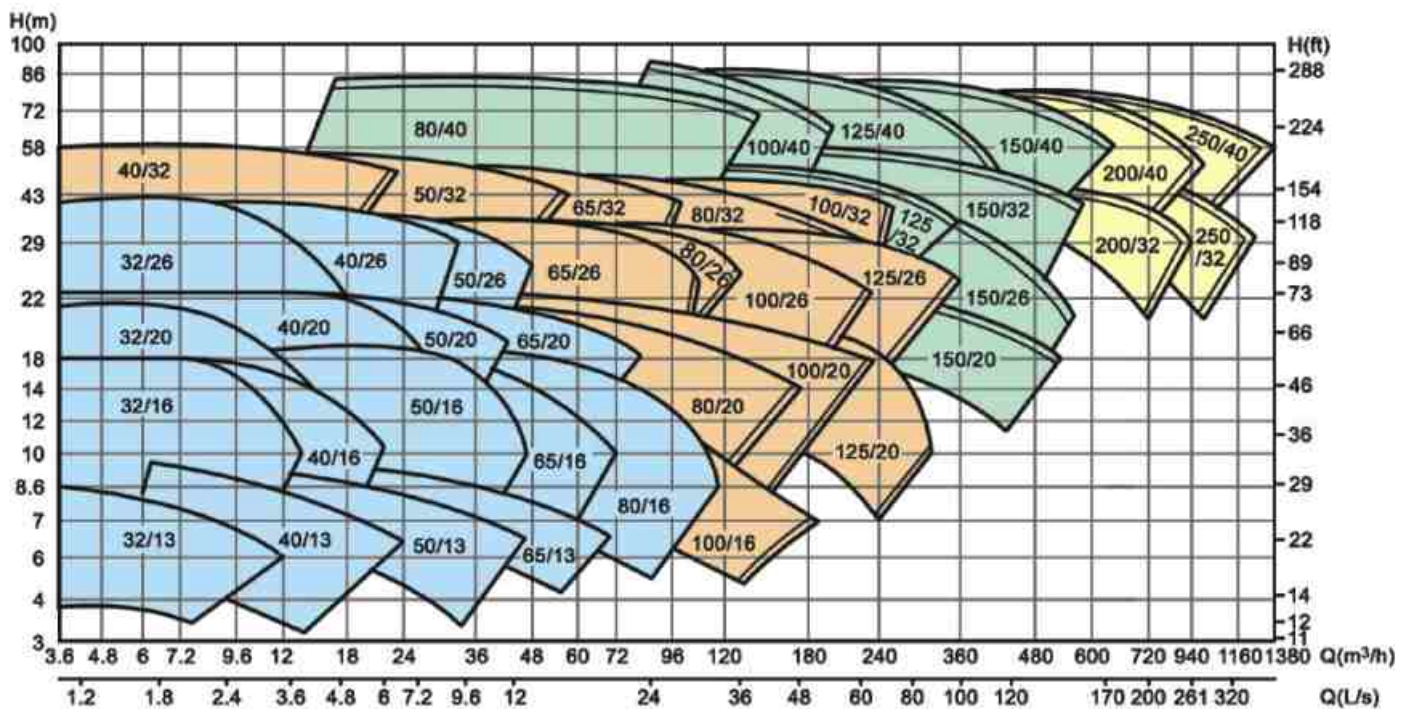

Range from 32mm to 250mm discharge

PA Series fully complies with both perform dimensional standards for the international Standard DIN 24255.

1. Bearing Housing

Rugged cast iron construction with 4 bearing housing covering the complete range of 47 pumps for maximum interchangeability.

2. Stuffing Box

Standard stuffing box includes gland packing and lantern ring with internal flushing or single mechanical seal with internal or external flush.

3. Shaft

One piece stainless steel shaft in 4 sizes covering the complete range of 47 pumps for maximum interchangeability.

4. Casing

The cast iron volute casing is heavy duty design with integral cast feet, vertical top centerline discharge and axial suction nozzle with cast inlet vane to improve flow into the impeller and reduce NPSH required.

5. Impeller

Double shrouded type, hydraulically balanced and positive drive shaft key and domed impeller lock nut.

6. Wear Rings

Replaceable wear rings are standard on all casings and on rear covers for larger pumps which assures hydraulic performance and reduces maintenance time and cost.

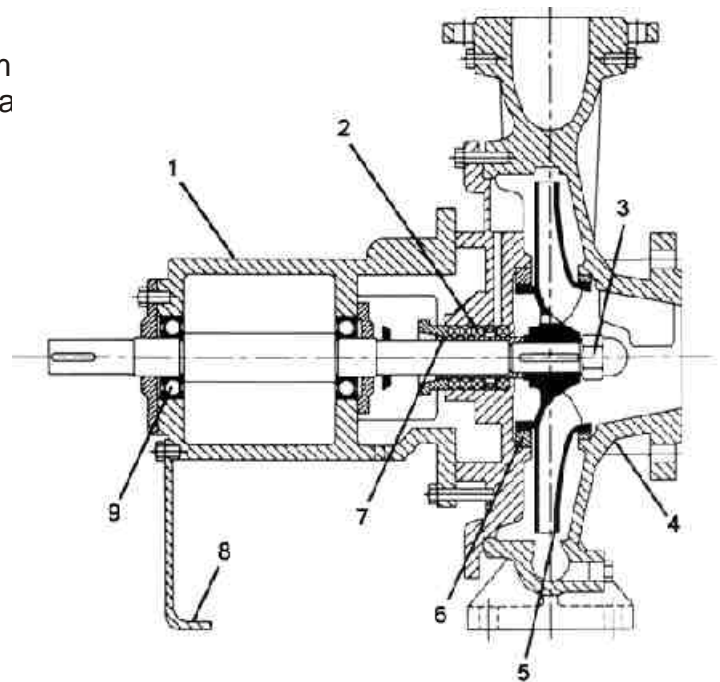

7. Shaft Sleeve

Replaceable fully machined, positively driven, hook type stainless steel shaft sleeve prevents damage to the shaft from gland packing or mechanical seal and reduces maintenance cost.

8. Support Foot

Removable and adjustable support foot provides added rigidity and ease of maintenance.

9. Bearings

All pumps come with SKF grease lubricated ball bearings as standard. Permanently, sealed greased bearings or oil lubricated bearing also available.

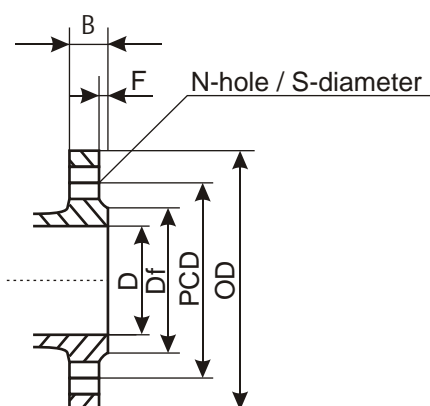

Flange Dimensions (mm)							
D	OD	B	Df	F	N	S	PCD
32	140	18	78	2	4	18	100
40	150	18	88	3	4	18	110
50	165	20	102	3	4	18	125
65	185	20	122	3	4	18	145
80	200	22	138	3	8	18	160
100	220	24	158	3	8	18	180
125	250	26	188	3	8	18	210
150	285	26	212	3	8	22	240
200	340	29	268	3	12	22	295
250	405	29	320	3	12	26	355
300	460	29	378	4	12	26	410



PA END SUCTION CENTRIFUGAL PUMP

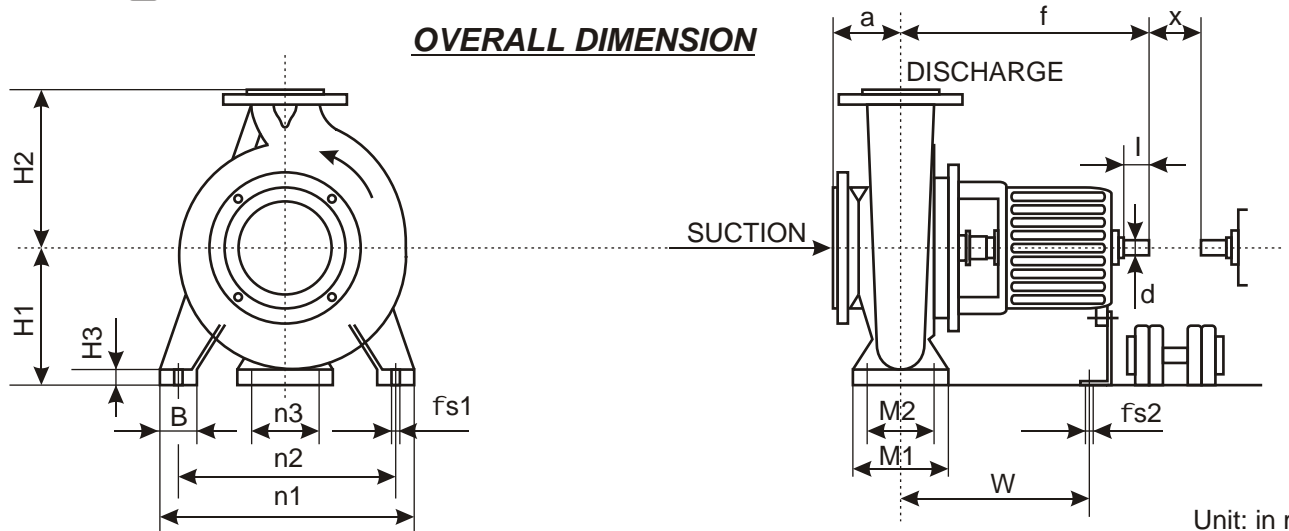

Unit: in mm

Model	Shaft Diameter	Inlet	Outlet	Pump Dimensions							Foot Dimensions							Shaft End	Coupling Key	Weight (Kg)		
				a	f	H1	H2	B	M1	M2	n ₁	n ₂	n ₃	H3	fs ₁	fs ₂	W				x	d
PA 32-13	25	50	32	80	360	112	140	50	100	70	190	140	100	14	14	14	267	140	24	50	8X7	28
PA 32-16				80		132	160	50	100	70	240	190	100									
PA 32-20				80		160	180	50	100	70	240	190	110									
PA 32-26				100		180	225	65	125	95	320	250	110									
PA 40-13	25	65	40	80	360	112	140	50	100	70	210	160	100	14	14	14	267	140	24	50	8X7	31
PA 40-16	80			132		160	50	100	70	240	190	100										
PA 40-20	100			160		180	50	100	70	265	212	110										
PA 40-26	100			180		225	65	125	95	320	250	110										
PA 40-32	125			200		250	65	125	95	350	280	110										
PA40/32H	125			250		65	125	95	350	280	110	362	42									
PA 50-13	25	65	50	100	360	132	160	50	100	70	240	190	110	14	14	14	267	140	24	50	8X7	34
PA 50-16	100			160		180	50	100	70	265	212	14										
PA 50-20	100			200		250	50	100	70	265	212	14										
PA 50-26	100			225		280	65	125	95	320	250	14										
PA 50-32	125			280		350	65	125	95	350	280	16										
PA50-32H	125			350		280	65	125	95	350	280	16										
PA 65-13	25	80	65	100	360	160	180	65	125	95	280	212	110	14	14	14	267	140	24	50	8X7	40
PA 65-16	100			200		65	125	95	280	212	14	14										
PA 65-20	100			225		65	125	95	320	250	14	14										
PA 65-26	100			250		80	160	120	360	280	14	14										
PA 65-32	125			280		80	160	120	400	315	16	18										
PA65-32H	125			315		80	160	120	400	315	16	18										
PA 80-16	25	100	80	125	360	180	225	65	125	95	320	250	110	14	14	14	267	140	24	50	8X7	55
PA 80-20	125			250		65	125	95	345	280	14	14										
PA 80-26	125			280		80	160	120	400	315	14	14										
PA 80-32	125			315		80	160	120	400	315	14	14										
PA80-32H	125			355		80	160	120	440	355	16	18										
PA 80-40	125			355		80	160	120	440	355	16	18										
PA 100-16	35	125	100	125	470	200	250	80	160	120	360	280	110	16	18	14	342	140	32	80	10X8	81
PA100-20	125			280		80	160	120	360	280	16	18										
PA100-26	140			320		80	160	120	400	315	16	18										
PA100-26H	140			350		80	160	120	400	315	16	18										
PA100-32	140			350		80	160	120	400	315	16	18										
PA100-32H	140			350		80	160	120	400	315	16	18										
PA100-40	140	350	100	200	150	500	400	18	23	370	42	110	12X8	177								
PA125-20	35	150	125	140	470	250	315	80	160	120	400	315	110	16	18	14	342	140	32	80	10X8	111
PA125-26	140			355		80	160	120	400	315	16	18										
PA125-32	140			355		100	200	150	500	400	18	23										
PA125-40	140			355		100	200	150	500	400	18	23										
PA150-20	35	200	150	160	495	280	400	100	200	150	550	450	110	20	18	14	367	140	32	80	10X8	140
PA150-26	160			355		100	200	150	550	450	18	23										
PA150-32	160			355		100	200	150	550	450	18	23										
PA150-40	160			355		100	200	150	550	450	18	23										
PA200-32	55	250	200	225	725	315	435	100	200	150	550	450	140	30	23	14	500	140	48	110	14X10	251
PA200-40		250	200	225	670	315	450	100	200	150	550	450	140									
PA250-32		300	250	250	693	400	500	100	270	180	500	400	180									
PA250-40		300	250	250	797	450	505	125	270	210	600	500	180									